



# VECTOR-35G

Precision Pan-Tilt Positioner

With its high torque capability, the Vector-35G accommodates a wide range of payloads from long range cameras to radar systems. The Vector-35G is ruggedized to ensure performance in the harshest environment and provide unmatched reliability. General Dynamics Ordnance and Tactical Systems' unique, proprietary design allows for 24/7 continuous operation without requiring homing or calibration.

The Vector-35G leverages our in-depth expertise in motion control systems. It provides superior control and accuracy. With precision hardened gearing and built-in control electronics, the system provides precise, smooth motion with high torque. It's perfect for long range sensors, and is also optimized for radar applications with complete EMI shielding.

General Dynamics Ordnance and Tactical Systems designs and manufactures high-performance motion systems and components that provide our customers the accuracy and reliability to successfully complete their mission. We leverage 40 years experience in motion technologies, to design and manufacture a full suite of pan-tilt systems.

## Communications

Connectors	Mil-Spec grade
Signals	2x Video, 2x Spare, 10/100BaseT, Power and Control
Control Interface	RS-232 (Standard)
Control Protocol	General Dynamics (Standard)

## Clarity. Accuracy. Reliability.

### Benefits:

- Supports a wide range of cameras, radars or other payloads, up to 35 pounds (15.9 kg)
- Simplified integration with table top mount and high torque
- Ruggedized and sealed to protect against vibration, temperature extremes, dust, sand, wind, rain, snow and ice
- Starts instantly; no warm up required
- Absolute position sensors require no homing or calibration
- 24/7 continuous operation

### Features:

- High speed & smooth motion up to 90°/sec
- 360° continuous pan rotation
- Low power consumption
- Low backlash precision gearing
- Upright or inverted installation options
- Software adjustable angular range limits

## Configuration Options

Finish	Other colors available upon request
Cable	Customizable per user specifications
Tilt	Range Configurable

# VECTOR-35G

Gear Driven Pan-Tilt System



## Pan-Tilt Performance

	Pan Axis	Tilt Axis
Speed	0.5 to 90 °/sec	1.0 to 15°/sec
Angular Range	360° continuous	-45° to +45°
Peak Torque	1,200 oz-in	8,000 oz-in
Accuracy	±0.1°	±0.1°
Repeatability	±0.05°	±0.20°
Resolution	0.005°	0.005°
Backlash	<0.1°	<0.25°
Duty Cycle	100%	100%

## Payload

Maximum Weight 35 lbs (15.9 kg)

## Environmental

Environmentally Sealed	Meets IP67 standard
Vibration	IEC 60945
Finish	Tan Powder Coat (Standard)
Operating Temperature	-40°C to +70°C (-40°F to +158°F)

## Weight

Weight 14 lbs (6.4 kg)

## Power Requirements

Operating Voltage	18-32 VDC
Power Consumption	8 Watts (Typical) 72 Watts (Max)

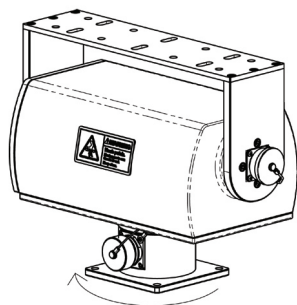

HOME POSITION  
CW DIRECTION POSITIVE

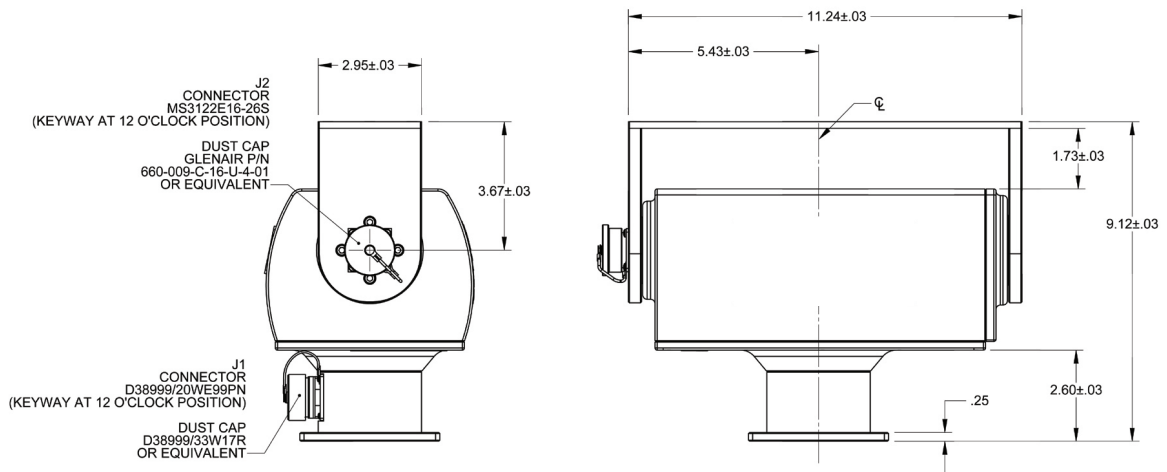
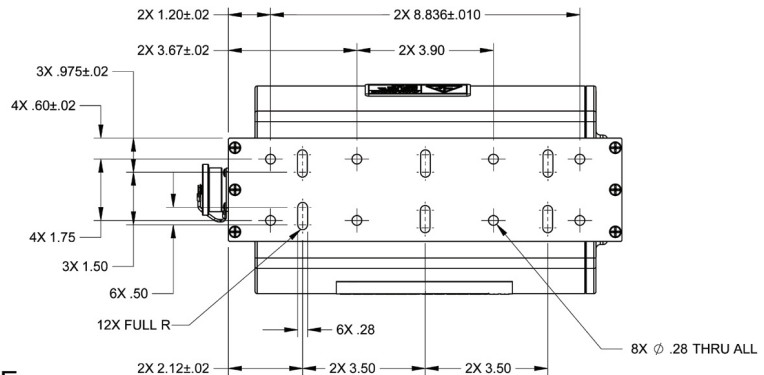

**GENERAL DYNAMICS**  
Ordnance and Tactical Systems

7603 St. Andrews Ave, Suite H - San Diego, CA 92154 - Phone (619) 671-5400 - [www.gd-ots.com/motion-control](http://www.gd-ots.com/motion-control)

Manufacturer reserves the right to change specifications to reflect latest changes in technology and improvements at any time without notice. Export is subject to U.S. Government regulations.

